

Overhang Clarification

June 28, 2022

To clarify how SMI measures overhangs and prevent misunderstanding of overhang sizing;

SMI's "standard" overhang size is 10". The 10" dimension is measured from the face of the adjacent wall stud to the outside of the fascia board.

So, on the graphic below, the 10" overhang finished dimension of the overhang is actually less than 9" when the OSB and the siding are installed.

Any additional layers that are added to the outside framing of the structure will affect the finished dimension of the overhang. Many of the additional layers are installed by the builder after the modules are delivered. Foam, brick, siding, Rainscreen.... All affect the finished dimension.

Finished dimension is not an accurate overhang dimension for us as the manufacturer. SMI is not responsible for the finished dimensions of additional layers that are added to the exterior of the building. All overhang dimensions are from the face of the stud to the outside of the fascia board, and should be noted that way.

SMI offers options for overhangs sized in 10", 12", 15", 20", and 24". In cases where the builder wants the overhang size adjusted to accommodate additional building material layers, it is the builder's responsibility to ensure their sales representative notes on the sales agreement what the dimension of the overhang will be. Custom overhang sizes are not available. With the options that we have in place, there should be a size that will work with most applications. The overhangs will be constructed according to the size of the overhangs noted on the sales agreement (measured from face of stud to outside of fascia board).

In addition, larger overhangs cannot be shipped installed on the modules, therefore, the builder must coordinate the overhang installation with the set crew, if they are not installing the overhangs themselves.

See following graphic.

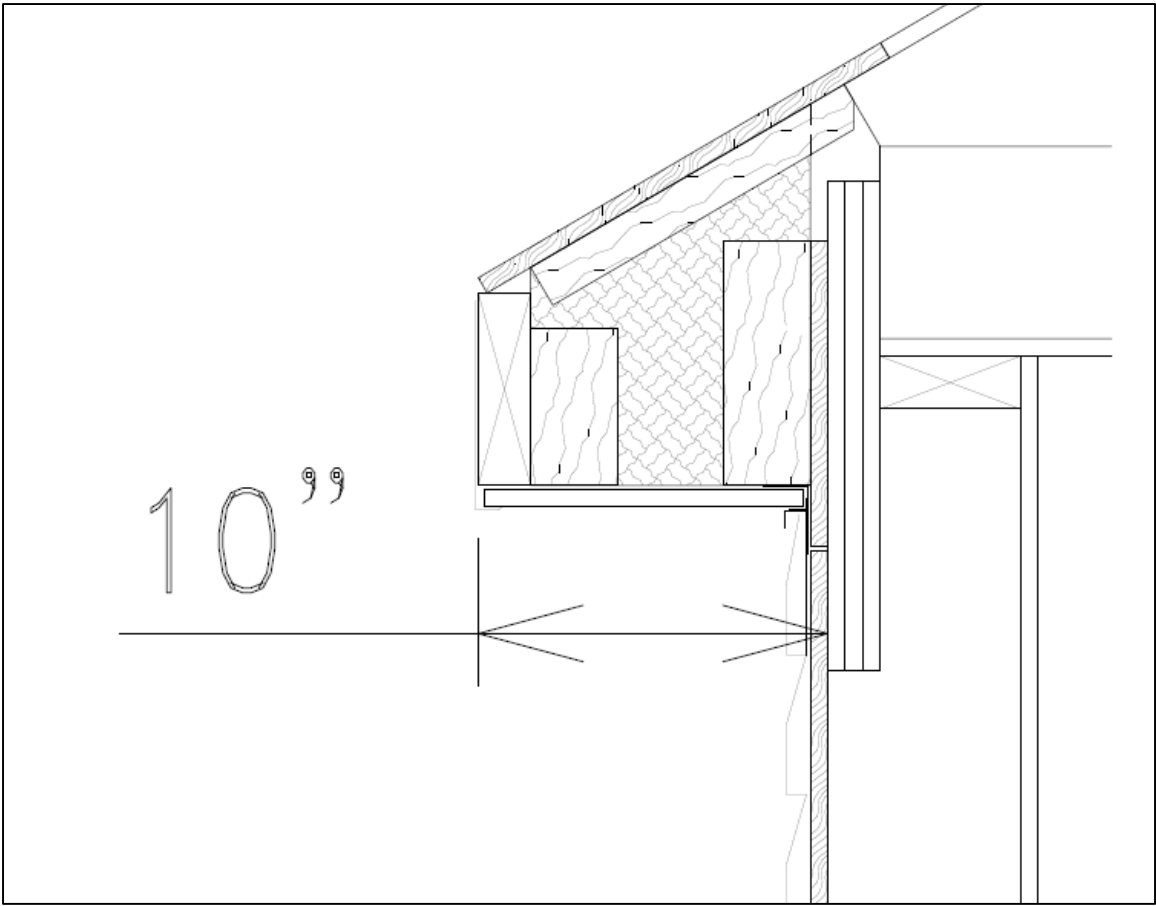

By following this dimensional standard, the builder is ensured of getting the product and finished look they want, and the production line can work more efficiently.

Thank you,
Jim Parkes
Structural Modulares, Inc.
101 Southern Ave.
Strattanville PA 16258
814-764-5555
www.smihomes.com